

# Canada & New England - 2023

**VERANDAH DECK**  
Staterooms 6100-6228

**NAVIGATION DECK**  
Staterooms 7001-7088

**LIDO DECK**

**SPORTS DECK**

## ZAANDAM

### DECK PLANS & STATEROOMS

The deck plans are color-coded by category of stateroom, and the category letter precedes the stateroom number in each room. All staterooms are equipped with flat-panel television, DVD player, telephone and multichannel music.

**Important Note:** Not all staterooms within each category have the same furniture configuration and/or facilities. Appropriate symbols within the rooms on the deck plans describe differences from the stateroom descriptions below.

#### VERANDAH SUITES

##### PS

**Pinnacle Suite:** Bedroom with 1 king-size bed, oversized whirlpool bath & shower, living room, dining room, dressing room, private verandah, pantry, 1 sofa bed for 2 persons, mini-bar, refrigerator, guest toilet, floor-to-ceiling windows.

##### SA SB

**Neptune Suites:** 2 lower beds convertible to 1 king-size bed, whirlpool bath & shower, large sitting area, dressing room, private verandah, 1 sofa bed for 2 persons, mini-bar, refrigerator, floor-to-ceiling windows.

##### A AA B BB BC

**Vista Suites:** 2 lower beds convertible to 1 queen-size bed, whirlpool bath & shower, sitting area, private verandah, mini-bar, refrigerator, floor-to-ceiling windows.

#### OCEAN-VIEW STATEROOMS

##### C

**Large:** 2 lower beds convertible to 1 queen-size bed, shower.

##### D DA DD E EE

##### F FF

**Large:** 2 lower beds convertible to 1 queen-size bed, bathtub & shower.

##### G H HH

**Large:** 2 lower beds convertible to 1 queen-size bed, bathtub & shower. All G-category staterooms have portholes. All H-category staterooms have partial sea views. All HH-category staterooms have fully obstructed views.

#### INTERIOR STATEROOMS

##### I J K L M

##### MM N

**Large:** 2 lower beds convertible to 1 queen-size bed, shower.

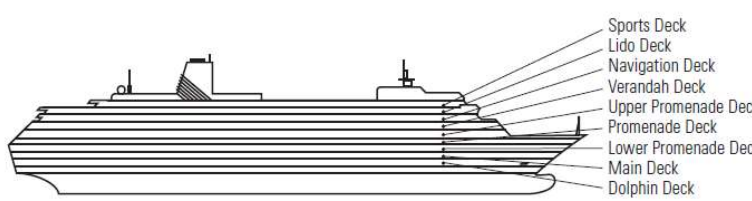
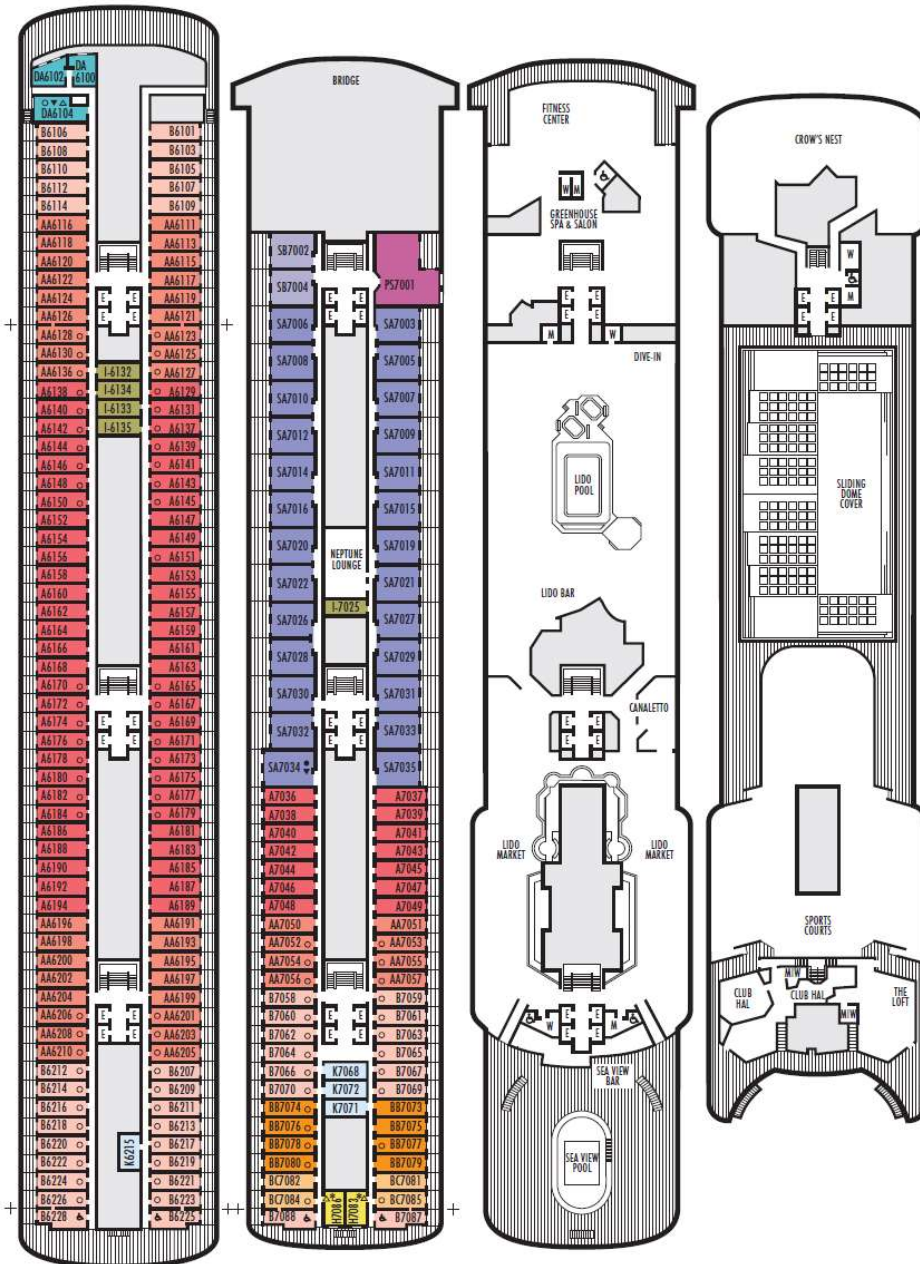

305 King Street West  
Suite 1004  
Kitchener, Ontario N2G 1B9

519.653.3500 or 1.800.265.8174  
journeys@jerryvandyke.com  
jerryvandyke.com

# Canada & New England - 2023

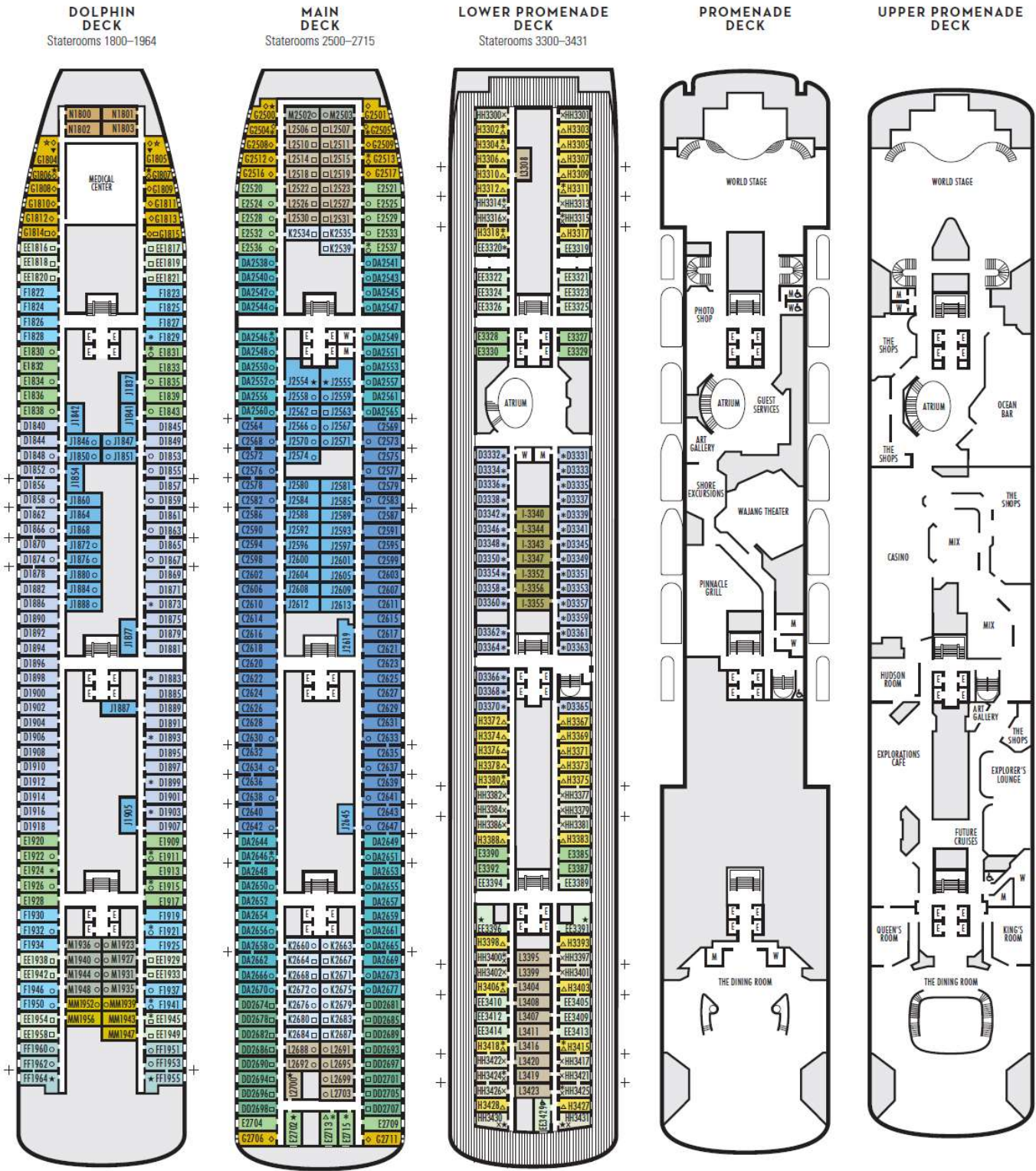

## STATEROOM SYMBOL LEGEND

- Quad (2 lower beds, 1 sofa bed, 1 upper)
- Triple (2 lower beds, 1 sofa bed)
- ☆ 2 lower beds not convertible to a queen-size
- △ Partial sea view
- × Fully obstructed view
- Bath tub & shower
- \* Shower only
- + Connecting rooms
- ◇ These staterooms have portholes instead of windows

## ACCESSIBILITY STATEROOM SYMBOL LEGEND

- ♿ Fully Accessible: Suites B7088, B7087, B6228 & B6225 and stateroom EE3429 have roll-in shower only
  - ▼ Fully Accessible with Single Side Approach: Suite SA7034 has a bathtub & roll-in shower. Staterooms DA6104, G1805 & G1804 have a roll-in shower only.
  - ★ Ambulatory Accessible: Staterooms EE3396, EE3391, HH3431, HH3430, E2702, L2700, J2555, J2554, G2500, FF1964, FF1955, G1807 & G1806 have a roll-in shower only
- For information regarding stateroom bedding configurations and accessibility features on our ships please visit the [Accessibility](#) section of our website.

## SHIP SPECIFICATIONS & FACILITIES

- 1,432 Guests
- 604 Crew
- 61,214 Gross Tons
- 780 Feet Long
- 9 Guest Decks
- Wraparound Promenade Deck
- 6 Restaurants & Cafes
- 6 Entertainment Venues
- 7 Lounges/Bars
- 2 Outdoor Swimming Pools (one with sliding glass roof)
- Spa & Salon
- Fitness Center
- Suite Lounge
- Duty-free Shops
- Library/Internet Cafe
- Onboard Wi-Fi Access
- Casino
- Sport Courts